

Floor Plan Piazza Mirabilis

VOID-SOLID

The project plays with the volumetric water capacity of the piscina. The inversion of the void is set on the top of the piscina. Since the piscina was a reservoir of water, the structure above becomes a reservoir as well: a reservoir for cultural exchange, social interaction and a space for all the citizens.

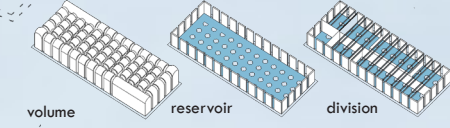
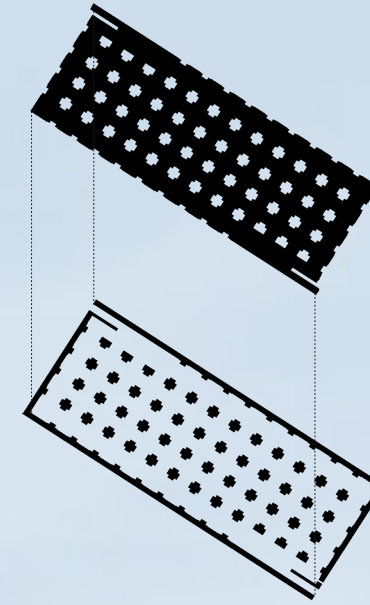

POZZOLANA

The volcanic ash from the area of the Campi Flegrei was used by the Romans as hydraulic binder for the roman concrete (opus caementitium).

The dark plaster of the outer structure represents the volcanic area and the revival of Roman building techniques.

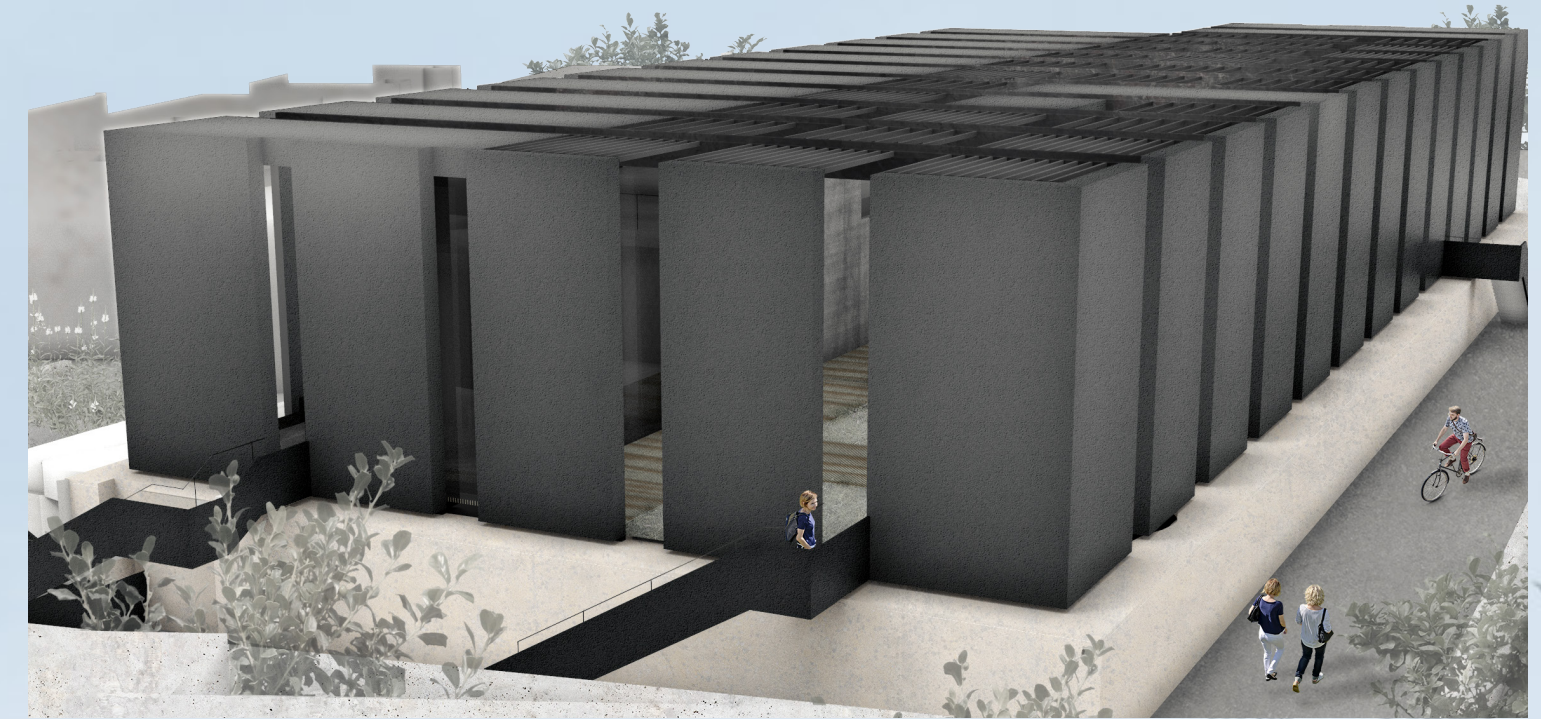

Section A-A

ART

An example for an artwork are the hanging installations '...the illuminating gas' of Cerith Wyn Evans. He works site specific with fluorescent tubes and focuses on how ideas can be communicated through form. The high contrast between the neon scribbles and the dark patina combined with the reflections on the water accentuates the perception of the space and guide the visitor through the exhibition.

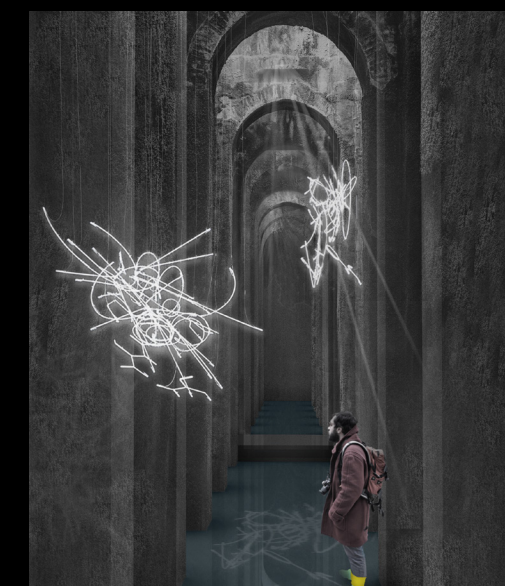

WATER

In roman times the reservoir saved water coming from the serino acqueduct and provided it for the people of Misenum. As the piscina now is emptied, it provides a large space for exhibitions. To get a new and extraordinary experience of the room it will be flooded with water to make a reminiscence to the Ancient times. Visitors can explore the exhibition area walking through the water wearing gumboots. They can be picked from a wheel after entering the exhibition space.

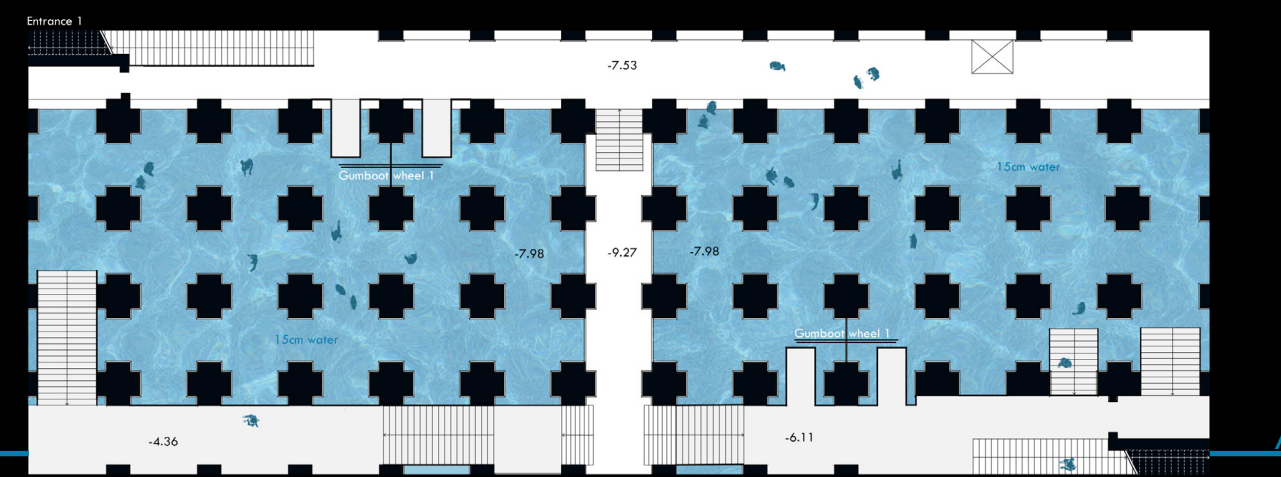
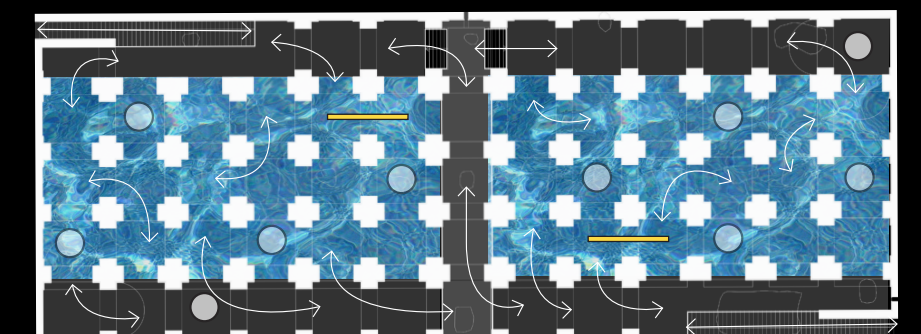

Floor Plan Piscina Mirabilis